

SHANA MCKAY BURNS ■ SET DESIGNER

810.423.9111 ■ shana@shanamburns.com ■ www.shanamburns.com ■ Member USA Local 829

Set Design

WandaVision – Streaming Series
The Conjuring 3 – Feature
The Glorias – Feature
The Banker – Feature
The Resident, season 1 – Television

Life of Crime – Feature (day player)
A Very Harold & Kumar Christmas – Feature

Producer
Static Productions LLC
Kiki Tree Pictures
The Glorias, LLC
Alabam Productions Inc.
20th Century Fox

Switch Productions
Santa Stash, LLC

Production Designer
Mark Worthington
Jennifer Spence
Kim Jennings
John Collins
Laurence Bennett
Geoffrey Grimsman
Inbal Weinberg
Rusty Smith

Art Direction

The View – Television
Good Morning America – Television
20/20 – Television
The Fast Times of Oscar Pistorius
Breaking Free, Breaking Bad

ABC
ABC
ABC

Seth Easter
Keven Lock
Keven Lock

Production Design

A Case of Blue – Feature
Gotham Comedy Live – Web Series
Entanglement – Short
The Volunteer – Feature
Honeysuckle – Feature
The Man from Shaolin – Feature
Pocket Pets – Web Series
The Santa Effect – Short
Line-Up – Short
Waiting for the General Decline – Short

Producer
Scott Rosenfelt
AXS TV
Hitman Productions
Instant Pictures
Breakfast Pictures
Man from Shaolin Films, LLC
House of Cards Productions
Don't Worry We'll Clean It Up
Roman Candle Productions
Lucero Films

Director
Dana H. Glazer
Bob Lampel
Adam Waltner
Vicky Wight
Vigil Chime
Richard T. Wong
Bob Lampel
Nic Kelman
Elisa Blatteis
Jason Lucero

Computer Graphics

Cellular South – Commercial – Lighting Artist
Bolt, add'l projects – Animation – Look Development Intern
The Mystery Dinosaur – Television – CG Generalist

Nathan Love
Walt Disney Feature Animation
Discovery Channel

Scenic Painting

The Substance of Fire – Feature
Going All the Way – Feature
A Brother's Kiss – Feature
He Got Game – Public Enemy Music Video

Producer
Goldhart Productions
Lakeshore Productions
Rosefunk Pictures Ltd.
Forty Acres and A Mule

Production Designer
John Lee Beatty
Therese DePrez
Roger Fortune

Theatre

Designed and assisted on multiple projects in NYC and regionally, including assisting Desmond Heeley on his Broadway production of *The Importance of Being Earnest*. Credits Available Upon Request

Education

M.F.A. Scenic Design
M.F.A. Digital Visualization & Animation
B.F.A. Drawing & Painting

Tisch School of the Arts, New York University
ACCAD, Ohio State University
Eastern Michigan University

Skills

AutoCAD, SketchUp, Layout, V-RAY, Photoshop, Microsoft Excel, Microsoft Word, Final Cut Pro 7
Hand Drafting & Sketching, Digital Rendering, Model-Building, Site Surveys

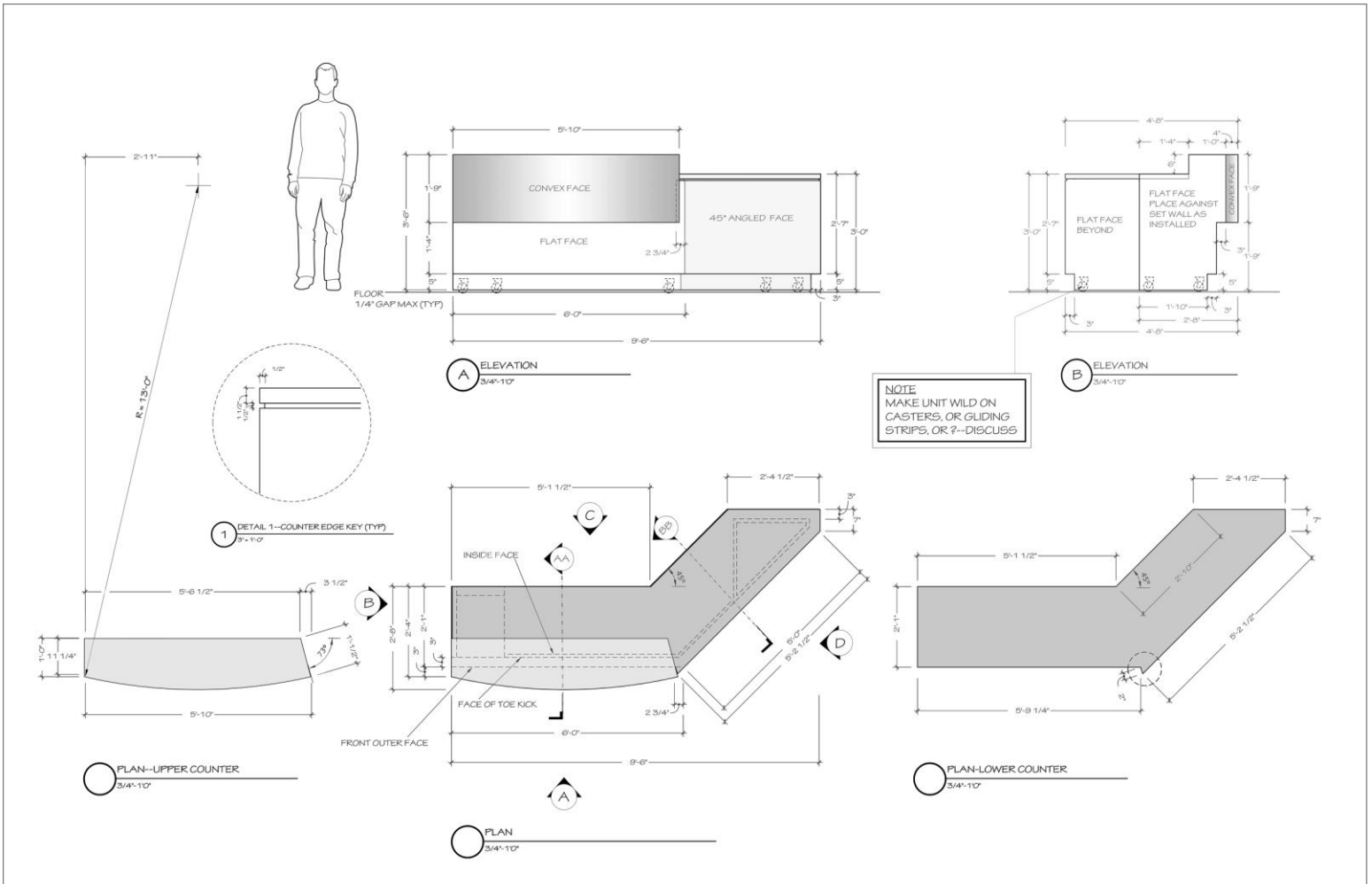

The Resident, 20th Century Fox, drafting sample—Nurses Station 2, NTS



SketchUp drafting and rendering samples